



V100E Positioner Wiring

www.vacaccessories.com

4-20 mA connection

Connecting the control signal

Remove the front cover and indicator.

Loosen the screw(1) enough so that the connection card can be lifted.

Secure the connection card into the small slot(2).

Terminal block screws are now easily accessible.

Connect the cables to its respective pole.

Max cable area $2,5 \text{ mm}^2$, ~AWG 13

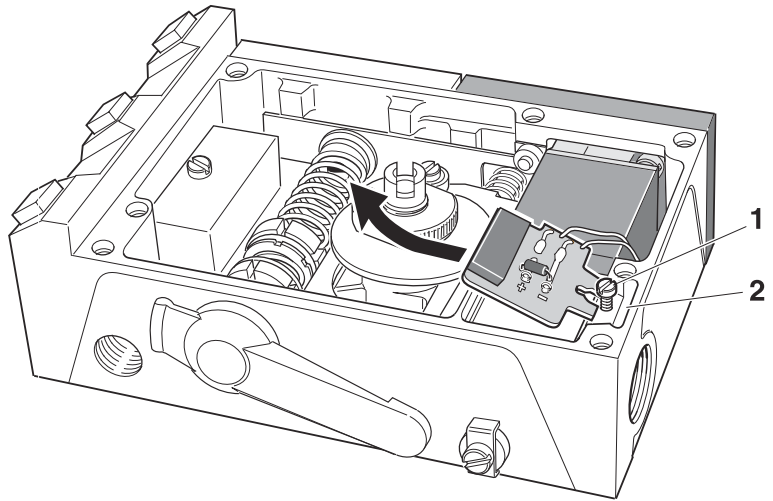

Checking the control signal

The control signal can be checked without having to break the signal loop. This is done by connecting a low ohmic ampere meter over the test points(3).

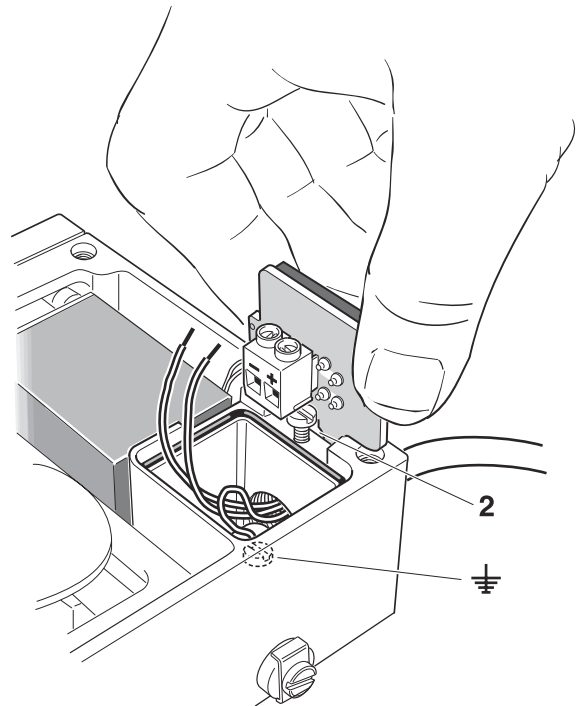

Bench test with the calibrator

When bench testing, it is possible to connect the control signal over the points(4) without having to loosen the connection card.

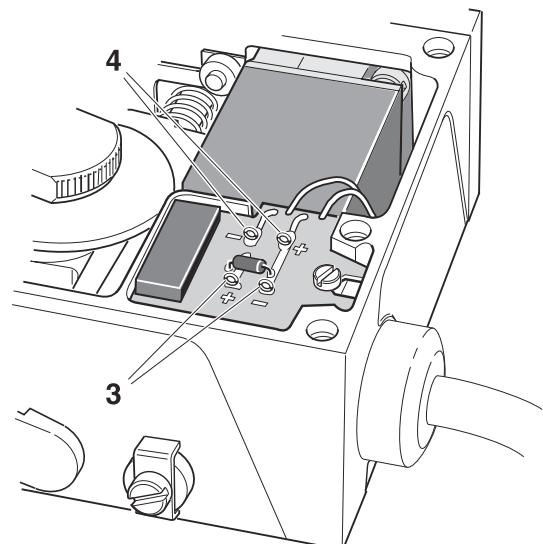

The I/P-converter is factory-adjusted. No extra range or zeroing adjustments are necessary.